

Application for Provisional Premises Licence

Applicant	Premises	
1.	Motor Fuel Limited	Ayr (Castlehill Road) Service Station Service Station Castlehill Road Ayr
Off Sale	Monday	10:00 – 20:00
	Tuesday	10:00 – 20:00
	Wednesday	10:00 – 20:00
	Thursday	10:00 – 20:00
	Friday	10:00 – 21:00
	Saturday	10:00 – 18:00
	Sunday	10:00 – 17:00

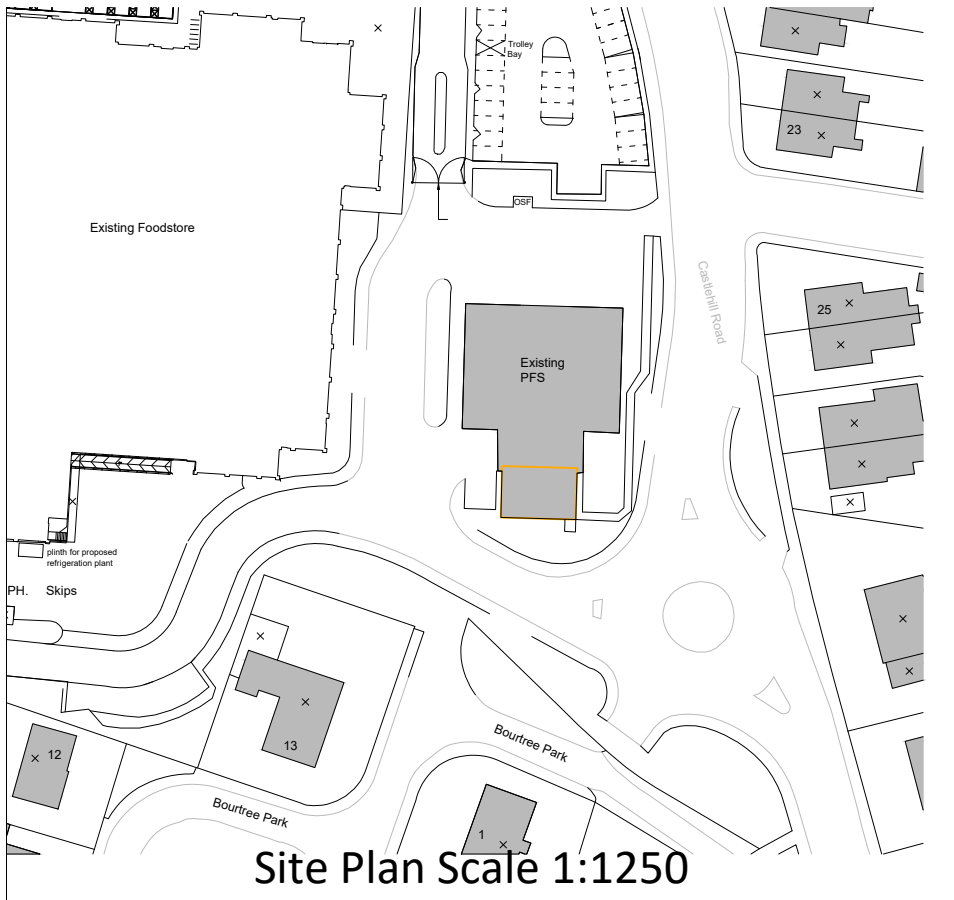

Children and young persons are permitted access to all public parts of the premises

Square Meters					
Store Name		Ayr			
Store Number		2165			
Number Of Units	Bay/Fixture	Height	Width	Depth	M2
0	Side Rack	1720	610	300	0.00000
Total Display Units Capacity					0.00000
1	1000 Fixture	1410	1000	470	1.41000
0.00	800 Fixture	1410	800	470	0.00000
2.00	Kiosk Kit	1800	1000	300	3.60000
0.00	1250 Panama fridge bay	1800	1250	750	0.00000
0.00	937 Panama fridge bay	1800	937	750	0.00000
2.00	1250 Gazelle fridge bay	1800	1250	750	4.50000
0.00	937 Gazelle fridge bay	1800	937	750	0.00000
Total Shelving Capacity					9.51000
Miscellaneous BWS Display Base					
Visible Display	Display Base	2200	610	610	0.00000
Total Department Capacity					9.51000

Key - Drawing Information

[Red Hatched]	FIXTURE LICENCED FOR SALE OF ALCOHOL - ACCESSIBLE
[Green Hatched]	FIXTURE LICENCED FOR SALE OF ALCOHOL - INACCESSIBLE
[Blue Line]	BOUNDARY OF PREMISES SALES FLOOR
[Yellow Line]	LOCATION OF PREMISES ON SITE PLAN

Key - Fire Symbols

[Square with X]	NOTICE - 'FIRE DOOR-KEEP CLOSED'
[Square with X]	NOTICE - 'KEEP LOCKED'
[Square with X]	ILLUMINATED EXIT DIRECTION
[Square with X]	EXIT SIGN
[Square with X]	EMERGENCY LIGHTING
[Square with X]	FIRE ALARM CALL POINT
[Square with X]	AUDIBLE WARNING
[Square with X]	SMOKE DETECTOR
[Square with X]	SMOKE DETECTOR
[Square with X]	ALARM INDICATOR PANEL
[Square with X]	DOORS FITTED WITH PUSH BARS
[Square with X]	DOORS FITTED WITH PRESSURE RELEASE
[Square with X]	GLASS SHUTTER DOOR
[Square with X]	FIRE EXTINGUISHER - WATER TYPE
[Square with X]	FIRE EXTINGUISHER - FOAM TYPE
[Square with X]	FIRE EXTINGUISHER - CARBON DIOXIDE
[Square with X]	FIRE EXTINGUISHER - DRY POWDER TYPE
[Square with X]	FIRE EXTINGUISHER - AQUEOUS SOLUTION
[Square with X]	FIRE EXTINGUISHER - VAPOURISING LIQUID
[Square with X]	FIRE BLANKET
[Square with X]	FIRE HOSE REEL
[Square with X]	FIRE RESISTANT WALLS
[Square with X]	FIRE RESISTANT DOORS

NOTES:

- FIRE FIGHTING EQUIPMENT & ALL OF THE REQUIREMENTS OF THE FIRE SERVICE WILL BE INCORPORATED & WILL BE PROVIDED TO COMPLY WITH THE EUROPEAN STANDARDS

No. BS EN3 & BS 7863.

FIRE STANDARDS:

- FIRE SAFETY RELATED SIGNS AND NOTICES ARE TO THE HEALTH AND SAFETY (SAFETY SIGNS & SIGNALS) REGULATIONS ACT 1996. THOSE THAT COMPLY TO BS 5499, PART 1, 1990 ALSO COMPLY.
- ILLUMINATED 'EXIT' SIGNS ARE TO CONFORM TO BS2560
- FIRE FIGHTING EQUIPMENT IS TO COMPLY WITH EUROPEAN STANDARDS BS EN3 AND BS 7863

NOTE:
TOTAL ALCOHOL DISPLAY AREA: 9.51000m²

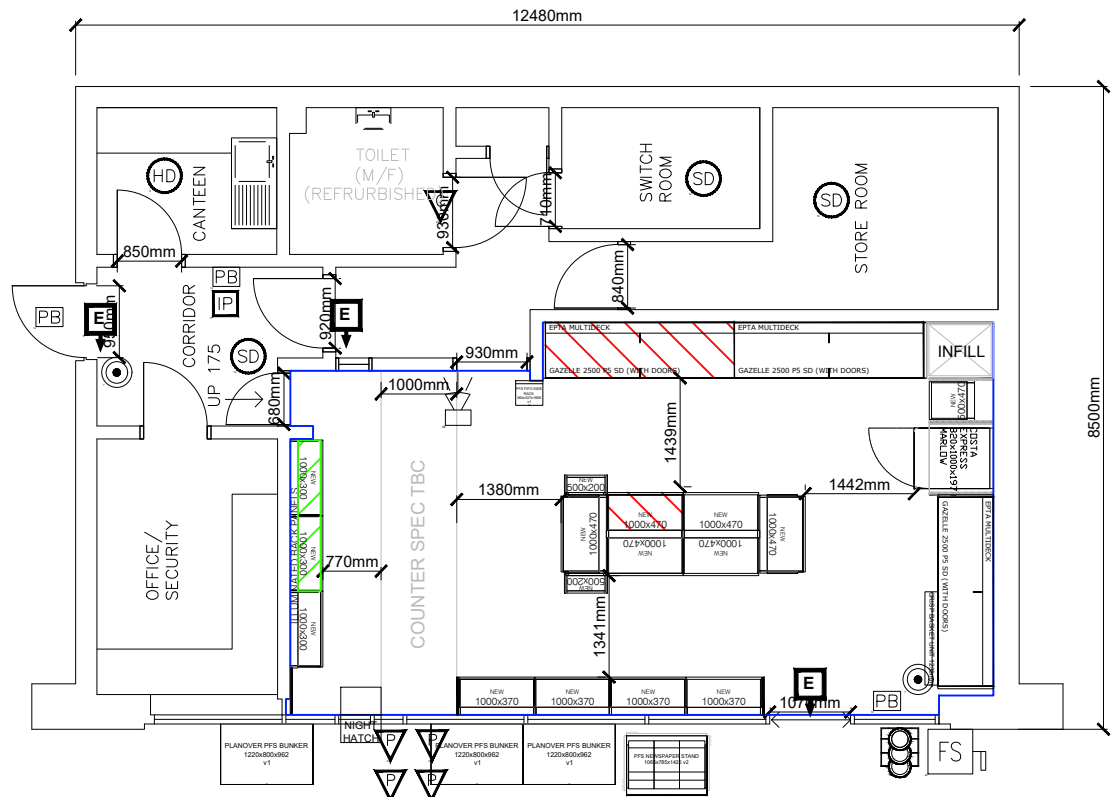

FS2165 Ayr Castlehill Road	
CASTLEHILL ROAD AYR KA7 2HT	
SALES FLOOR	
RETAIL SALES AREA	491 Sq. Ft.
Scale: 1:100	only scaled on A3