

Application for Variation of Premises Licence

1.	Aldi Stores Limited	Aldi 33 Main Street Ayr
<p>Add to operating plan "Click and collect service and on line sales/deliveries may also take place during and outwith core hours."</p> <p>Increase capacity of premises -</p> <ul style="list-style-type: none">• The permanent capacity is increased to 32.77 sq m.• The seasonal capacity is increased to 7.2 sq m.• Overall capacity is increased to 39.97 sq m. <p>An amendment to seasonal capacity is also sought so that the seasonal display is in effect: Christmas: 1 December to 31 December annually. Easter: Seasonal display to commence a week prior to Easter Sunday (as it falls) for a duration of 21 days.</p>		

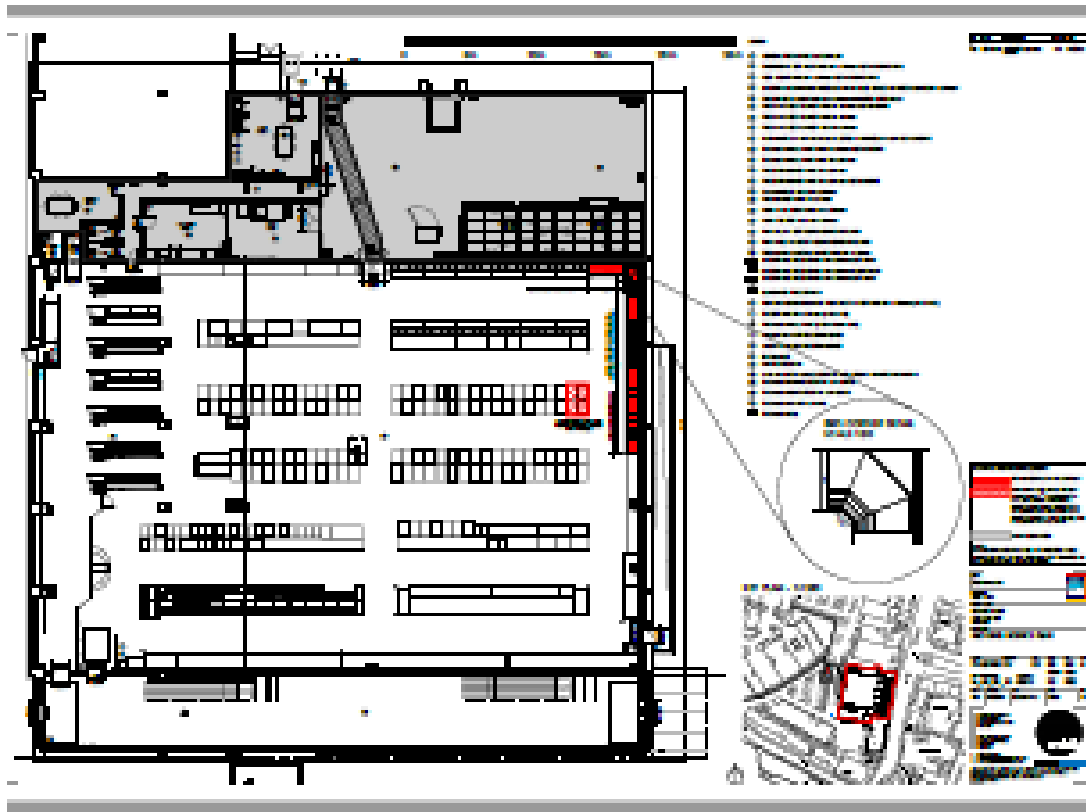

2.

Buzzworks Hospitality Limited	Quei Bravi Ragazzi 18 West Portland Street Troon			
	Existing Licensed Hours		Proposed Licensing Hours	
	On Sales	Off Sales	On Sales	Off Sales
Monday	10:00 – 00:00	N/A	10:00 – 00:00	N/A
Tuesday	10:00 – 00:00	N/A	10:00 – 00:00	N/A
Wednesday	10:00 – 00:00	N/A	10:00 – 00:00	N/A
Thursday	10:00 – 00:00	N/A	10:00 – 00:00	N/A
Friday	10:00 – 00:00	N/A	10:30 – 01:00	N/A
Saturday	10:00 – 00:00	N/A	10:30 – 01:00	N/A
Sunday	10:00 – 00:00	N/A	10:00 – 00:00	N/A

Amend licensed hours as above
 Add seasonal variations – one additional hour 1st December to 2nd January
 Add conference facilities during and outwith core licensed hours. Include restaurant facilities outwith core licensed hours.
 Include weddings, funerals, birthdays, retirements and other receptions outwith core licensed hours. Also include club or other group meetings within and outwith core licensed hours.
 Include recorded music and live performances outwith core licensed hours, include films, gaming, indoor/outdoor sports and televised sports within and outwith core licensed hours.
 Include conference facilities, restaurant facilities, receptions, meetings and staff meetings, staff events and televised sport may take place outwith core licensed hours but no alcohol will be served outwith these hours without reference to the Board.
 Include karaoke, quiz, live bands, comedians, darts, theme nights, fruit machine and golf simulator.
 Children to be allowed access to the premises when accompanied by an adult until 22.30 for the purpose of having a meal or attending a function. Young persons will be allowed entry to the premises to 22.30 for the purpose of having a meal or attending a function.
 Change name of the premises to “The Fox”
 Building Standards advise that a completion certificate for the premises has not as yet been issued

